

LCD / Keyboard combination

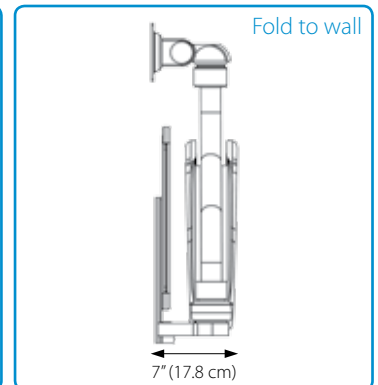

Features:

- Conveniently and ergonomically position your monitor and keyboard for maximum productivity and comfort
- Extension from the wall ranges from 9" (22.9 cm) to 34" (86.4 cm) depending on model selected
- Entire system easily folds back to 7" (17.8 cm) from wall for storage when not in use
- Includes both 75/100 VESA mounting plates
- Integrated cable management system on arm and on wall channel neatly organizes and conceals cables
- Several configurations available to best suit your application and space
- CPU mount available in several sizes
- Various color options at no additional charge (white is standard)

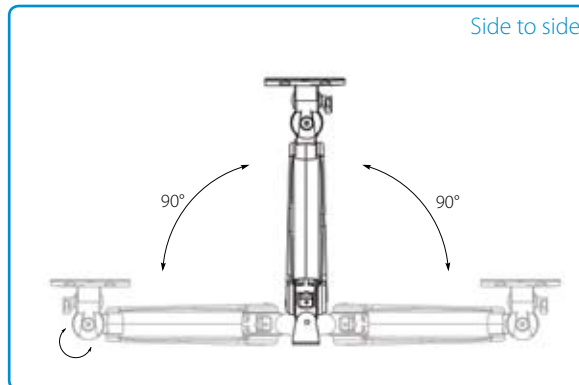
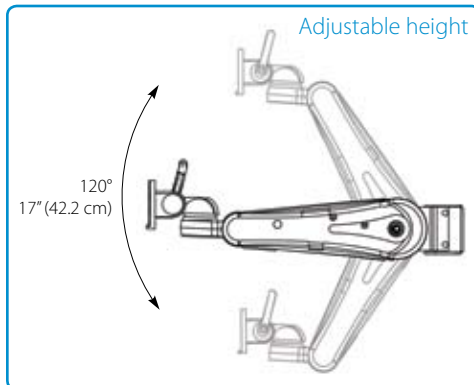

Additional **SSM IT Station Configurations**

Dual Arm SSM IT Station with 9" extension



- Each arm extends up to 9" (22.9 cm) from wall
- Swivel arm provides 180° degrees of lateral motion
- Each arm folds back to wall when not in use
- 60 lbs (27.2 kg) weight rating per arm

Call for part number

Combination SSM IT Station with 9" extension



- Entire system extends up to 9" (22.9 cm) from wall
- Swivel arm provides 180° degrees of lateral motion
- Entire system folds back to wall when not in use
- 60 lbs (27.2 kg) weight rating

Part Number: SSM-IT-25

Dual Arm SSM IT Station with 12" extension



- Each arm extends up to 12" (30.5 cm) from wall
- Swivel arm provides 180° degrees of lateral motion
- Each arm folds back to wall when not in use
- 60 lbs (27.2 kg) weight rating per arm

Call for part number

Combination SSM IT Station with 12" extension



- Entire system extends up to 12" (30.5 cm) from wall
- Swivel arm provides 180° degrees of lateral motion
- Entire system folds back to wall when not in use
- 60 lbs (27.2 kg) weight rating

Part Number: SSM-IT-05

Dual Arm SSM IT Station with 9" x 9" extension



- Each arm extends up to 16" (41 cm) from wall
- Swivel arm provides 180° degrees of lateral motion
- Each arm folds back to wall when not in use
- 30 lbs (13.6 kg) weight rating per arm

Call for part number

Combination SSM IT Station with 9" x 9" extension



- Entire system extends up to 16" (41 cm) from wall
- Swivel arm provides 180° degrees of lateral motion
- Entire system folds back to wall when not in use
- 30 lbs (13.6 kg) weight rating

Part Number: SSM-IT-35

Dual Arm SSM IT Station with 12" x 12" extension



- Each arm extends up to 22" (56 cm) from wall
- Swivel arm provides 180° degrees of lateral motion
- Each arm folds back to wall when not in use
- 30 lbs (13.6 kg) weight rating per arm

Call for part number

Combination SSM IT Station with 12" x 12" extension



- Entire system extends up to 22" (56 cm) from wall
- Swivel arm provides 180° degrees of lateral motion
- Entire system folds back to wall when not in use
- 30 lbs (13.6 kg) weight rating

Part Number: SSM-IT-15

Additional **AHM IT Station Configurations**

Dual Arm AHM IT Station



- Each arm extends up to 18" (45.7 cm) from wall
- Both side to side and adjustable height flexibility
- Each arm folds back to wall when not in use
- 30 lbs (13.6 kg) weight rating per arm

Call for part number

Combination AHM IT Station



- Entire system extends up to 18" (45.7 cm) from wall
- Both side to side and adjustable height flexibility
- Entire system folds back to wall when not in use
- 30 lbs (13.6 kg) weight rating

Part Number: AHM-IT-05

Dual Arm AHM IT Station with 9" extension



- Each arm extends up to 27" (68.6 cm) from wall
- Both side to side and adjustable height flexibility
- Each arm folds back to wall when not in use
- 30 lbs (13.6 kg) weight rating per arm

Call for part number

Combination AHM IT Station with 9" extension



- Entire system extends up to 27" (68.6 cm) from wall
- Both side to side and adjustable height flexibility
- Entire system folds back to wall when not in use
- 30 lbs (13.6 kg) weight rating

Part Number: AHM-IT-35

Dual Arm AHM IT Station with 12" extension



- Each arm extends up to 30" (76.2 cm) from wall
- Both side to side and adjustable height flexibility
- Each arm folds back to wall when not in use
- 30 lbs (13.6 kg) weight rating per arm

Call for part number

Combination AHM IT Station with 12" extension



- Entire system extends up to 30" (76.2 cm) from wall
- Both side to side and adjustable height flexibility
- Entire system folds back to wall when not in use
- 30 lbs (13.6 kg) weight rating

Part Number: AHM-IT-15

Dual Arm AHM IT Station with 16" extension



- Each arm extends up to 34" (86.4 cm) from wall
- Both side to side and adjustable height flexibility
- Each arm folds back to wall when not in use
- 30 lbs (13.6 kg) weight rating per arm

Call for part number

Combination AHM IT Station with 16" extension



- Entire system extends up to 34" (86.4 cm) from wall
- Both side to side and adjustable height flexibility
- Entire system folds back to wall when not in use
- 30 lbs (13.6 kg) weight rating

Part Number: AHM-IT-55

Additional IT Station Accessories

Power Bar



- Hospital grade, 4 power outlets
- 120 VAC, 60Hz

Part Number: POWER4-MON

Power Holder



- Holds most power adapters for PCs, patient monitors and LCDs

Part Number: PWRHLD-MON

CPU Mount

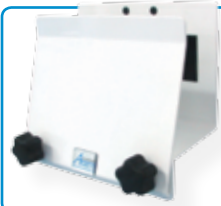

- Conveniently mounts CPU to wall channel ranging in sizes from 1.5" (3.8 cm) to 9.5" (45.7cm)
- Call with dimension of CPU width

Call for part number.

Cord Hooks



- Manage cables, cords and other hanging wires
- Attach to the bottom of any monitor arm

Part Number: CRDHLD

Monitor Channel



- Standard wall channel 19" (48.3cm)
- Seismic options are available and custom lengths are welcome

Part Number: MRS-019

Channel Cover



- Easy way to hide wires
- Available in patterns and colors to match any decor

Call for part number.

Small Storage Basket

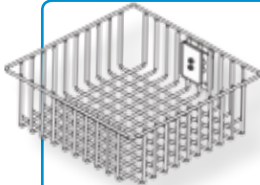

- 10"W x 10"D x 4" H white wire basket
- Can be sterilized

Part Number: 101004-MON-BB

BP Cuff Basket



- Conveniently holds single BP Cuffs to wall channel
- Can be sterilized

Part Number: CUFBASK-MON

Medium Storage Basket

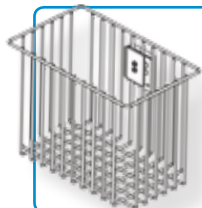

- 10"W x 06"D x 09" H white wire basket
- Can be sterilized

Part Number: 100609-MON-BB

Large Storage Basket

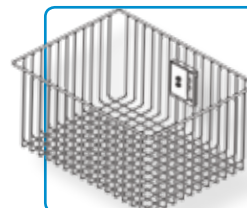

- 13"W x 09"D x 07" H white wire basket
- Can be sterilized

Part Number: 130907-MON-BB

Please visit www.amico.com for all technical specifications, installation instructions, detailed AutoCAD drawings and more mounting solutions.



Distributed By:

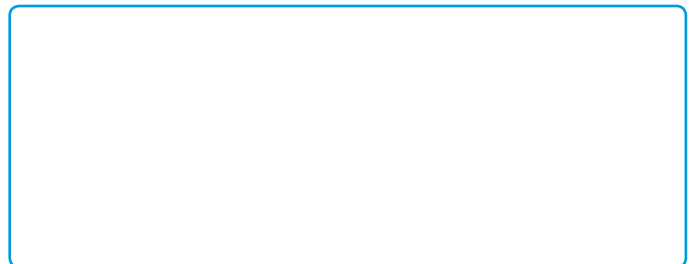

SP-IT-074

the right connection